

### LSD Series High Induction Linear Slot Diffuser

**Material** | Extruded aluminum and extruded PVC sectored deflection vanes

**Air Pattern** | Adjustable

**Ceiling Types** | Open and Closed



**LSD**  
by MADEL®

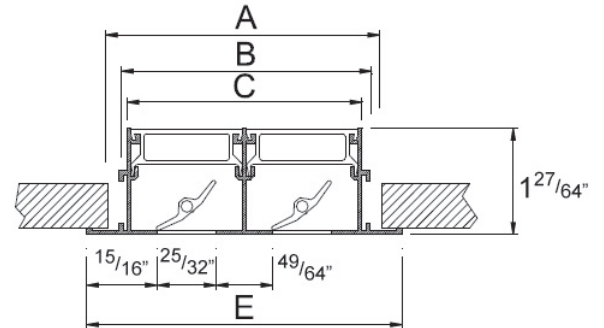
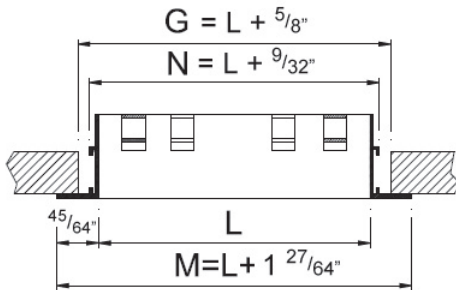

Select Length

✓	Standard Length	L	G	M
	Standard 36"	35 7/16"	36 1/16"	36 27/32"
	Standard 48"	46 19/64"	46 59/64"	47 3/4"
	Standard 60"	59 1/16"	59 11/16"	60 15/32"
	Standard 72"	70 55/64"	71 1/2"	72 9/32"
	Custom (specify) :		L + 5/8"	L + 1 27/64"

Select Number of Slots

✓	Nb Slots	E	A	B	C
	<b>1</b>	2 43/64"	2 11/64"	1 27/32"	1 19/32"
	<b>2</b>	4 7/32"	3 47/64"	3 25/64"	3 9/64"
	<b>3</b>	5 49/64"	5 9/32"	4 15/16"	4 45/64"
	<b>4</b>	7 5/16"	6 13/16"	6 31/64"	6 1/4"

### Airflow Balancing

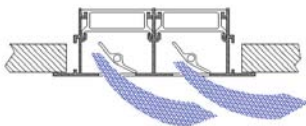

1 Way

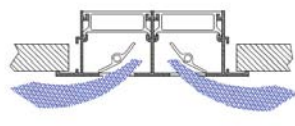

2 Way

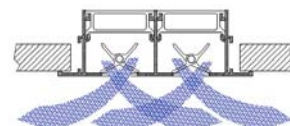

2 Way Alternate  
(Default)



Vertical

### PLSD Plenum (Side Connection)

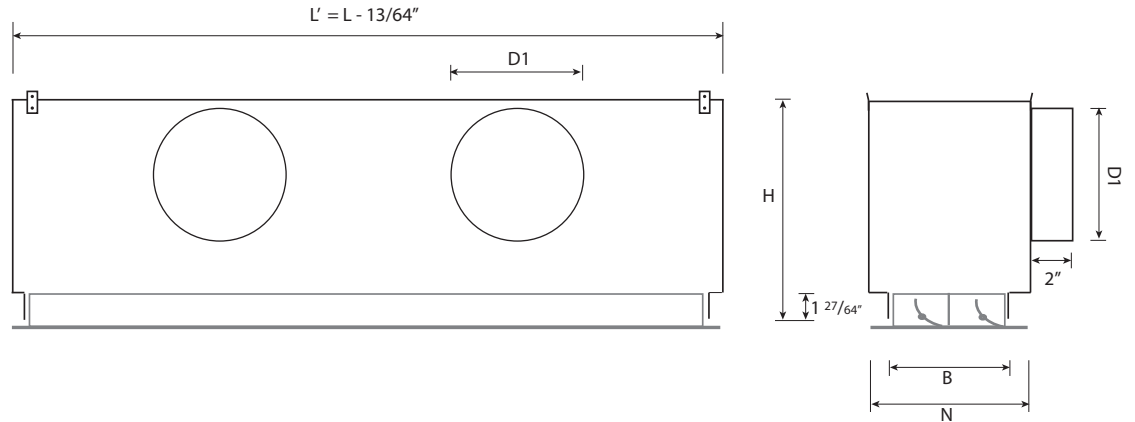

PLSD Plenum								
Nb Slots	H	B	N	D1 $L \leq 19 \frac{11}{16}''$	D1 $L \leq 39 \frac{3}{8}''$	D1 $L \leq 47 \frac{1}{4}''$	D1 $L \leq 59 \frac{1}{16}''$	D1 $L = 78 \frac{47}{64}''$
1	10 5/64"	1 27/32"	2 23/32"	1x 6"D	1x 6"D	1x 6"D	1x 6"D	2x 6"D
2	10 5/64"	3 25/64"	4 1/4"	1x 6"D	1x 6"D	1x 6"D	2x 6"D	2x 6"D
3	11 21/32"	4 15/16"	5 25/32"	1x 8"D	1x 8"D	2x 8"D	2x 8"D	2x 8"D
4	11 21/32"	6 31/64"	7 21/64"	1x 8"D	1x 8"D	2x 8"D	2x 8"D	2x 8"D

### PLSD-T Plenum (Top Connection)

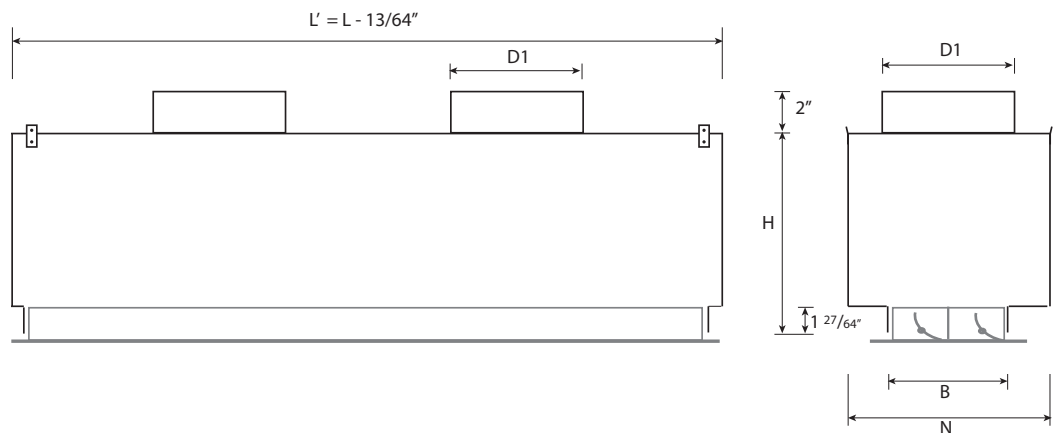

PLSD-T Plenum								
Nb Slots	H	B	N	D1 $L \leq 19 \frac{11}{16}''$	D1 $L \leq 39 \frac{3}{8}''$	D1 $L \leq 47 \frac{1}{4}''$	D1 $L \leq 59 \frac{1}{16}''$	D1 $L = 78 \frac{47}{64}''$
1	8"	1 27/32"	6 7/8"	1x 6"D	1x 6"D	1x 6"D	1x 6"D	2x 6"D
2	8"	3 25/64"	6 7/8"	1x 6"D	1x 6"D	1x 6"D	2x 6"D	2x 6"D
3	10"	4 15/16"	8 7/8"	1x 8"D	1x 8"D	2x 8"D	2x 8"D	2x 8"D
4	10"	6 31/64"	8 7/8"	1x 8"D	1x 8"D	2x 8"D	2x 8"D	2x 8"D

### PM Mounting Kit

PM Mounting Kit consists of C shaped clips with long screws. Recommended for installation without plenum.

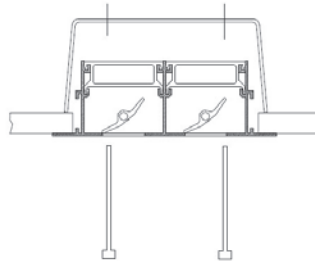

### PL Hidden Mounting System

PL Hidden Mounting System consists of spring clips attached to the diffuser and special brackets attached to the plenum.

The clips have a two steps profile. The hooks must first be inserted into the brackets. The hooks secure the product in place, even when submitted to intense vibrations, making it safe for ceiling installation.

The second step only requires to push the diffuser until it lays flush with the gypsum or plenum opening. The spring pressure maintains the product in place.

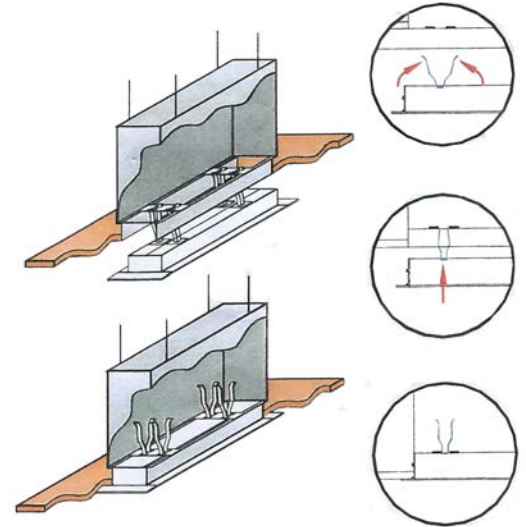

### Integrated Air Volume Dampers

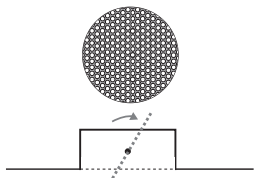

**R**

Perforated damper +  
air equalizer

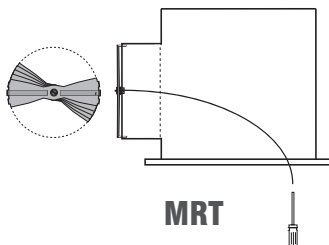

**MRT**

Manually operated damper,  
cable inside the plenum,  
adjustment through face

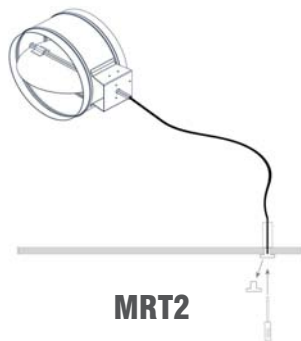

**MRT2**

Manually operated damper,  
cable through drywall with  
termination fixture



**EB**

Battery operated  
electro-balance damper  
with remote control,  
cable through face

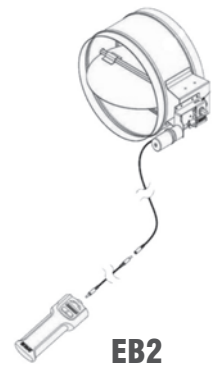

**EB2**

Battery operated  
electro-balance damper  
with remote control,  
cable through drywall  
with termination fixture

End Borders	
<b>AR</b>	Two End Borders
<b>ARI</b>	Left End Border Only
<b>ARD</b>	Right End Border Only
<b>INT</b>	No End Border (Central Sections)

Mounting	
<b>PL</b>	Concealed Spring Clips (requires PLSD)
<b>PM</b>	Concealed U Clip
<b>T</b>	Visible Screws

Sectored Vanes Color	
<b>AN</b>	Black
<b>AB</b>	White

Finish	
<b>/M9016</b>	Powder Coated White RAL 9016 (standard)
<b>/AA</b>	Anodized in matt silver with black vanes
<b>/RAL xxxx</b>	Other (specify) :

Plenum	
<b>PLSD</b>	Side connection & hidden spring clips attachment system
<b>PLSD-T</b>	Top connection & hidden spring clips attachment system

Neck-Installed Air Volume Damper		Cable Length
<b>R</b>	Perforated air volume damper/equalizer	
<b>MRT</b>	Manually operated, cable through face	
<b>MRT2</b>	Manually operated, drywall termination fixture	
<b>EB</b>	Electro-balanced, battery powered, cable through face	
<b>EB2</b>	Electro-balanced, battery powered, termination fixture	

Insulation	
<b>AL</b>	1/2" Interior Accoustical Liner
<b>AL1</b>	1" Interior Accoustical Liner
<b>R6</b>	2" Exterior R6 Thermal Insulation

Air Equalizing Grid	
<b>EQ</b>	Perforated plate / air equalizer

Airflow Balancing (Optional)	
<b>W1</b>	1 Way
<b>W2</b>	2 Way
<b>W2A</b>	2 Way Alternate (Default)
<b>V</b>	Vertical

<b>Project:</b>
<b>Engineer:</b>
<b>Architect:</b>
<b>Contractor:</b>