

### AX6-MA Series Manually Adjustable Blades Round Swirl Diffusers

**Material** | Powder coated heavy gauge spun aluminum with steel blades.

**Air Pattern** | 360° diffusion with horizontal swirl to downward flow, manual synchronous adjustment of the blades.

**Ceiling Types** | Open and Closed.



**AX6-MA**  
by MADEL®

| Select Model |                   |      |     |     |     |     |
|--------------|-------------------|------|-----|-----|-----|-----|
| ✓            | Model             | Duct | A   | C   | E   | H   |
|              | <b>AX6-MA 250</b> | 250  | 300 | 248 | 360 | 202 |
|              | <b>AX6-MA 315</b> | 315  | 400 | 313 | 464 | 225 |
|              | <b>AX6-MA 400</b> | 400  | 500 | 401 | 560 | 250 |
|              | <b>AX6-MA 500</b> | 500  | 620 | 497 | 690 | 306 |
|              | <b>AX6-MA 630</b> | 630  | 780 | 627 | 870 | 350 |

All dimensions in millimeters (mm)

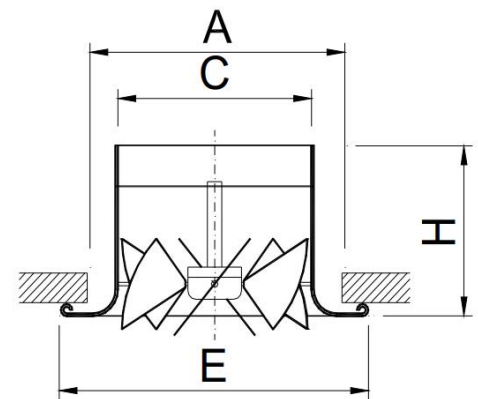

| Optional CH6 Security Grille |                |      |      |    |    |
|------------------------------|----------------|------|------|----|----|
| ✓                            | Model          | Dext | Dint | A  | H  |
|                              | <b>CH6 250</b> | 350  | 300  | 40 | 14 |
|                              | <b>CH6 315</b> | 450  | 400  | 40 | 14 |
|                              | <b>CH6 400</b> | 550  | 500  | 50 | 17 |
|                              | <b>CH6 500</b> | 655  | 600  | 80 | 17 |
|                              | <b>CH6 630</b> | 860  | 790  | 90 | 20 |

All dimensions in millimeters (mm)

### CH6 Security Grille

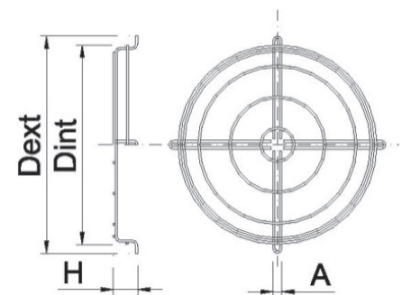

### Air Volume Dampers

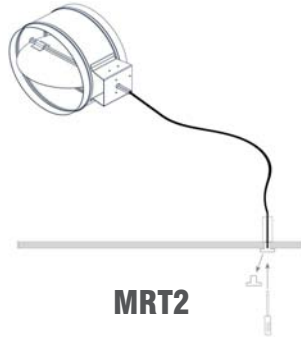

**MRT2**

Manually operated damper, cable through drywall with termination fixture

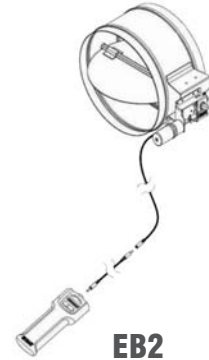

**EB2**

Battery operated electro-balance damper with remote control, cable through drywall with termination fixture

**No cable length limitation, recommended for AX6 diffusers installed in high ceilings**

| Neck-Installed Air Volume Damper |  |
|----------------------------------|--|
| <b>MRT2</b>                      | Manually operated, termination fixture                 |
| <b>EB2</b>                       | Electro-balanced, battery powered, termination fixture |

| Cable Length |  |
|--------------|--|
|              |  |

| Select Finish |                                |
|---------------|--------------------------------|
|               | Powder Coated White (RAL 9016) |
|               | Mill Finish                    |
|               | Other RAL (specify) :          |

|   |
|---|
| <p><b>Project:</b></p> <p><b>Engineer:</b></p> <p><b>Architect:</b></p> <p><b>Contractor:</b></p> |
|---|